

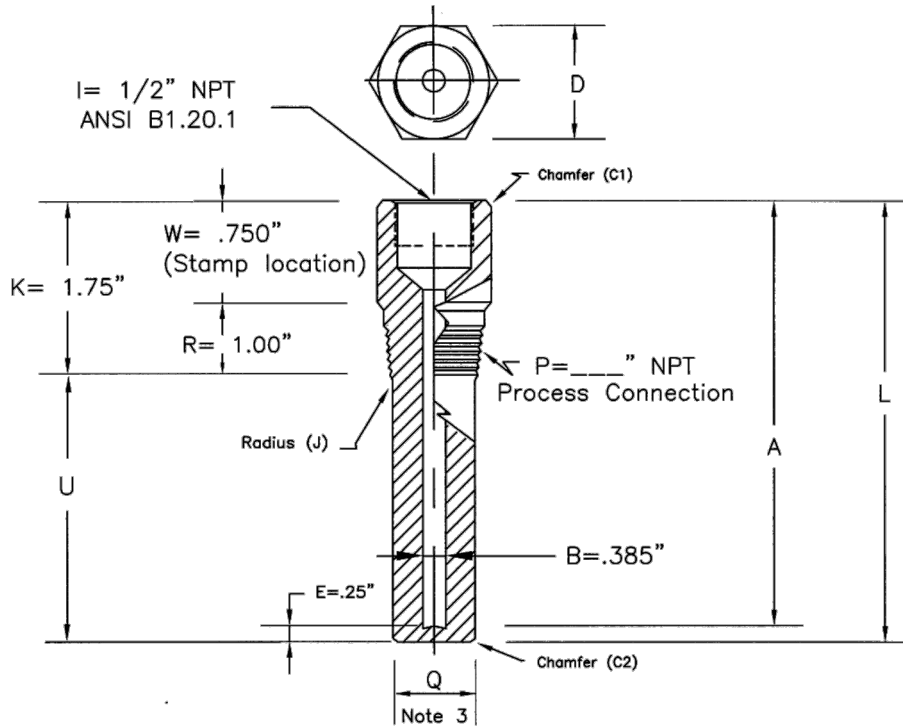

THERMOCOUPLE TECHNOLOGY, INC.

Threaded
Straight
.385" Bore



T 5 0	<p>1/2" Process Connection Style 10029 Specifications: See Notes 1-4 a. "W" = 1.00", "R" = .750" and b. "D" = 1-1/8" hex, See Note 2</p>	<p>1. STANDARD BIMET LENGTHS:</p> <table border="1"> <thead> <tr> <th>"A"</th> <th>"U"</th> <th>"L"</th> </tr> </thead> <tbody> <tr> <td>2.5"</td> <td>1</td> <td>2.75"</td> </tr> <tr> <td>2.5"</td> <td>1.625</td> <td>See Limited Space Series</td> </tr> <tr> <td>4"</td> <td>2.5</td> <td>4.25"</td> </tr> <tr> <td>6"</td> <td>4.5</td> <td>6.25"</td> </tr> <tr> <td>9"</td> <td>7.5</td> <td>9.25"</td> </tr> <tr> <td>12"</td> <td>10.5</td> <td>12.25"</td> </tr> <tr> <td>15"</td> <td>13.5</td> <td>15.25"</td> </tr> <tr> <td>18"</td> <td>16.5</td> <td>18.25"</td> </tr> <tr> <td>24"</td> <td>22.5</td> <td>24.25"</td> </tr> </tbody> </table> <p>2. STANDARD HEX MATERIALS: 304:304/Lss 316:316/Lss CS:CS 1018 BR: Brass a. Other material grades are available only in round bar with (2) wrench flats.</p> <p>3. STANDARD SHANK O.D.s: T50 Q1 = .680" T75: Q1 = .766" T10: Q1 = .875"</p> <p>4. TOLERANCES: Reference document: Series T</p>	"A"	"U"	"L"	2.5"	1	2.75"	2.5"	1.625	See Limited Space Series	4"	2.5	4.25"	6"	4.5	6.25"	9"	7.5	9.25"	12"	10.5	12.25"	15"	13.5	15.25"	18"	16.5	18.25"	24"	22.5	24.25"
"A"	"U"		"L"																													
2.5"	1		2.75"																													
2.5"	1.625	See Limited Space Series																														
4"	2.5	4.25"																														
6"	4.5	6.25"																														
9"	7.5	9.25"																														
12"	10.5	12.25"																														
15"	13.5	15.25"																														
18"	16.5	18.25"																														
24"	22.5	24.25"																														
T 7 5	<p>3/4" Process Connection Style 10011 Specifications: See Notes 1-4 "D" = 1-1/8" hex, See Note 2</p>																															
T 1 0	<p>1" Process Connection Style 10012 Specifications: See Notes 1-4 "D" = 1-3/8" hex, See Note 2</p>																															

STYLES 10029, 10011, 10012

Thermocouple Technology, Inc.
350 New Street
Quakertown, Pa 18951
Phone: 215-529-9394 FAX: 215-529-9397 www.tteconline.com